

# 28' x 68' Classroom

## Building Details:

Asset #: CR00063B  
Building Size: 28 x 68  
Square Footage: 1,904  
Occupancy: E - Education  
Roof Load: 20 PSF  
Wind Load: 130 MPH  
Floor Load: 80 PSF Corridor, 40 Elsewhere  
Electrical: Single Phase / 125 AMP Panel / 120/240 Volts

## Exterior Details:

Siding Material: Aluminum  
Roofing Material: .045 EPDM  
Frame: Perimeter  
Windows: (12) Vertical Slide  
HVAC: (2) 3.5 Ton / 10 kw Heat Strip

## Interior Details:

Wall Finish: Vinyl Covered Gypsum  
Floor Finish: Carpet  
Lighting: Recessed  
Ceiling: T-Grid

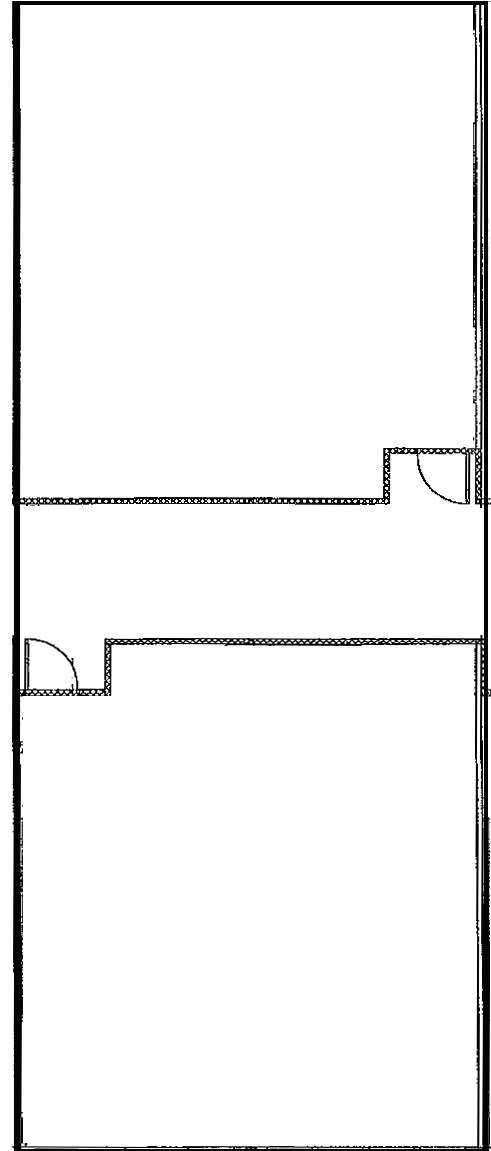

\*\*This building is subject to availability. The details provided are for informational purposes only and are not guaranteed. For detailed specifications, drawings and pricing contact your local representative.