

# 24' x 60' Classroom

## Building Details:

Asset #: CR00355- CR00356

Building Size: 24 x 60

Square Footage: 1,440

Occupancy: E - Education

Roof Load: 30 PSF

Wind Load: 90 MPH

Floor Load: 40 PSF

Electrical: Single Phase / 200 AMP / 120/240 Volts

## Exterior Details:

Siding Material: 8" Groove Sierra Hardi-Panel

Roofing Material: .045 EPDM

Frame: Outrigger

Doors: (2) Single

Windows: 8

HVAC: (2) 3 Ton / 15 kw Heat Strip

## Interior Details:

Wall Finish: Vinyl Wrap Gypsum Board

Floor Finish: Vinyl Tile

Lighting: Fluorescent

Ceiling: Hard (Popcorn)

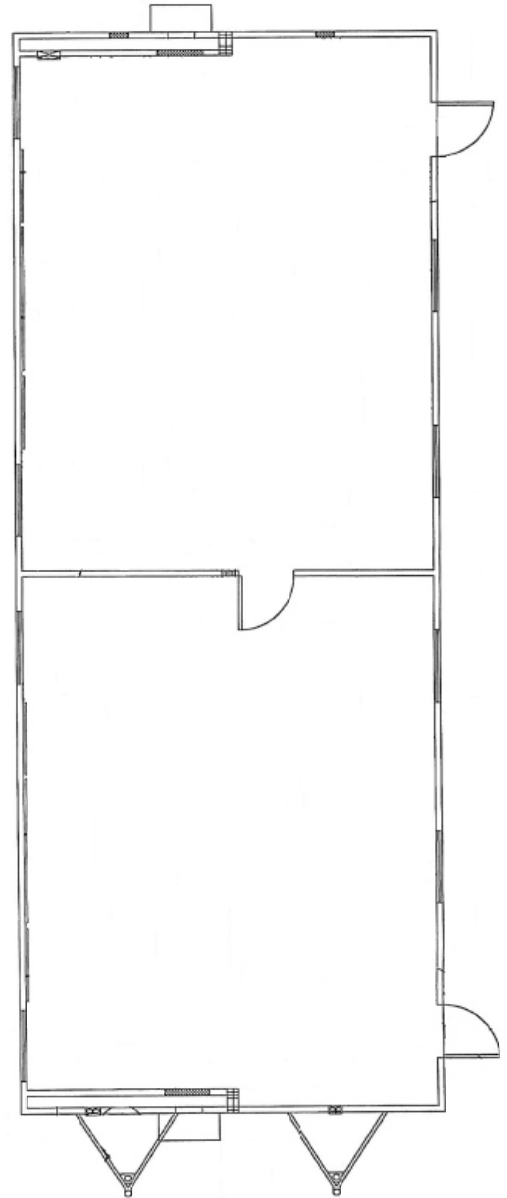

\*\*This building is subject to availability. The details provided are for informational purposes only and are not guaranteed. For detailed specifications, drawings and pricing contact your local representative.