

24' x 64' Classroom

Building Details:

Asset #: CR00444
State Seal: LA, TX
Building Size: 24 x 64
Square Footage: 1536
Occupancy: E - Educational
Roof Load: 20 PSF
Wind Load: 130 MPH
Floor Load: 50 PSF
Electrical: Single Phase / 200 AMP Panel / 120/240 Volts

Exterior Details:

Siding Material: 26 Gauge Hi Rib Steel
Roofing Material: .045 EPDM
Frame: Outrigger
Doors: (2) Single
Windows: (4) Horizontal Slide
HVAC: (2) 3 Ton / 10 kw Heat Strip

Interior Details:

Wall Finish: 1/2" Vinyl Covered Gypsum
Floor Finish: Vinyl Covered Tile
Lighting: 2 x 4 Troufer
Ceiling: T-Grid (Acoustical)

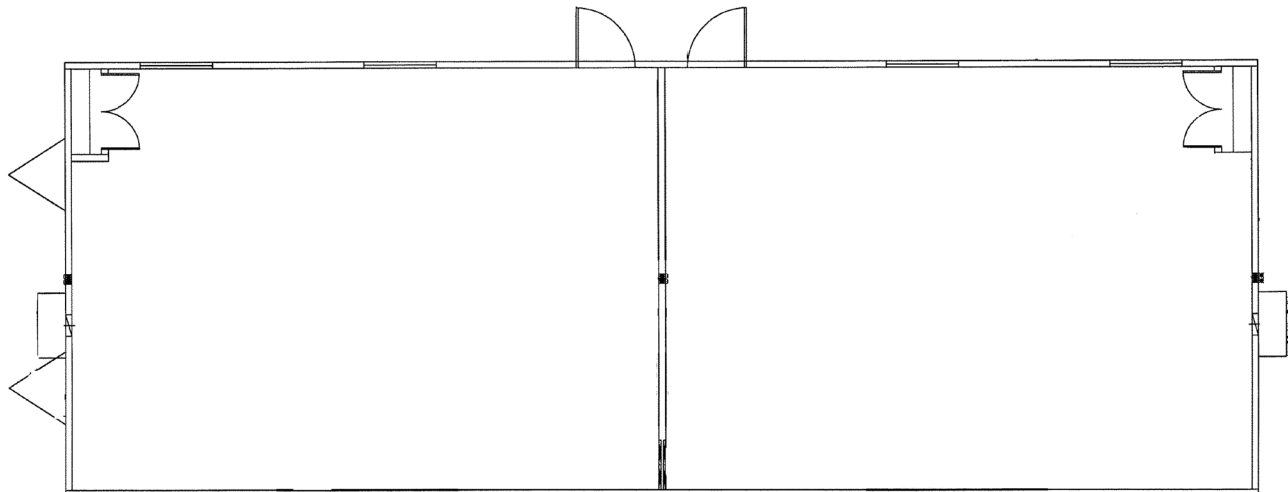

**This building is subject to availability. The details provided are for informational purposes only and are not guaranteed. For detailed specifications, drawings and pricing contact your local representative.