

24' x 66' Classroom

Building Details:

Asset #: CR00231, 232, 233

State Seal: VA, MD, NC

Building Size: 24 x 66

Square Footage: 1584

Occupancy: E - Educational

Roof Load: 20 PSF

Wind Load: 120 MPH

Floor Load: 40 PSF

Electrical: Single Phase / 100 AMP Panel / 120/240 Volt

Exterior Details:

Siding Material: .019 Aluminum

Roofing Material: .045 EPDM

Frame: Outrigger

Doors: (2) 36 x 80

Windows: (6) 36 x 53

HVAC: (2) 3 Ton Wall Mount / 10kw Heat Strip

Interior Details:

Wall Finish: Vinyl Covered Gypsum

Floor Finish: Carpet

Lighting: (24) Surface Mount with T-8 Bulbs

Ceiling: Seaspray

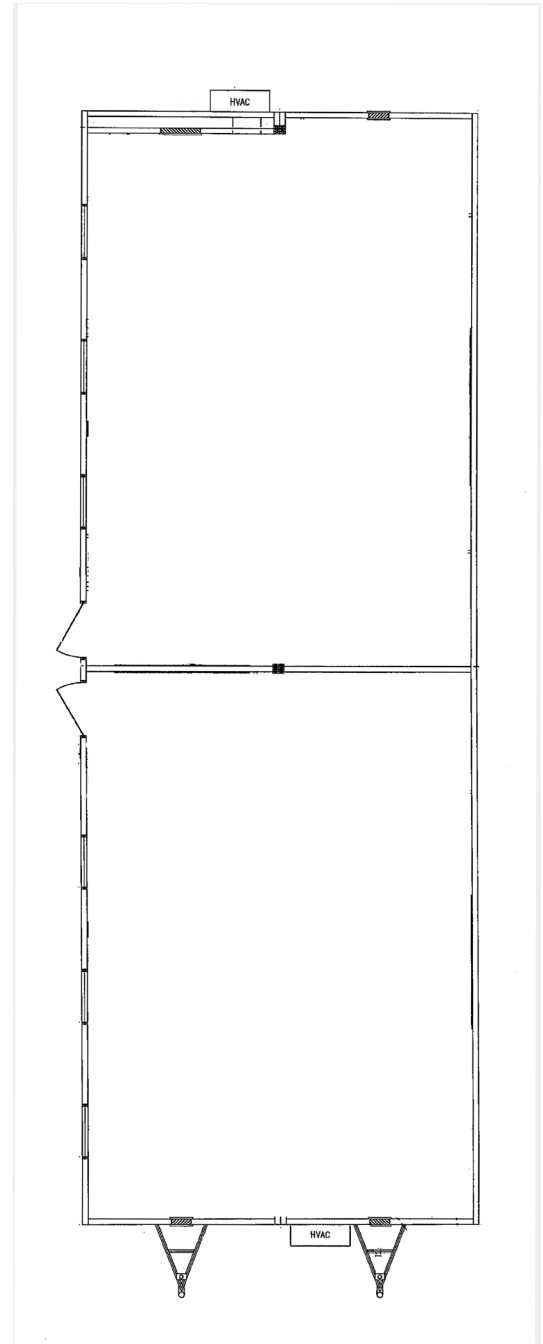

**This building is subject to availability. The details provided are for informational purposes only and are not guaranteed. For detailed specifications, drawings and pricing contact your local representative.